

## LIGHT SOURCE

LED quantity L=30 cm	31
Power max	8 W/m – 12 W/m
Total lumen output L=30 cm (3000K)	128 lm (8 W/m)
Efficacy lm/W (3000K)	376 lm/W
LOR (3000K)	-
CRI	>80 – >90
LED Temperature (K)	2700K CRI>90 – 3000K CRI>90 – 4000K CRI>90 – 5000K
Average operational life	50.000 hours

## OPTIC

Material	Polycarbonate
Available optics	Opal cover – transparent cover
Beam direction	Fixed
Flux symmetry	Symmetrical
Accessories	-

## LED FIXTURE

Material	Aluminum
Finish	Aluminum Hard Coat Anodizing (Gray, Black)
Available finishes	Gray, Black
IP Rate	IP40
Working Temperature	-20° ÷ +40°
Accessories	Brackets with screws, Magnetic brackets

## ELECTRICAL FEATURES

Driver	Remote
Dimmable	Push, 1-10V, DALI
For emergency lighting	-
Connection	In parallel at 24Vdc
Class	III

## MECHANICAL FEATURES

Dimensions (mm)	8 x 8 x L
Weight	90 gr/m
Mounting	Wall, Ceiling, Floor mounting
Cut-out (mm)	-
Use	Indoor

## NOTES

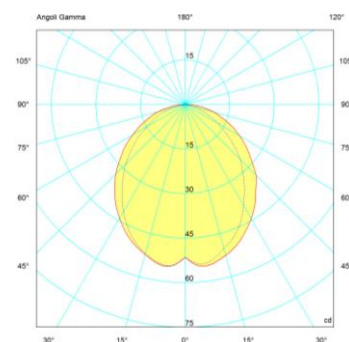
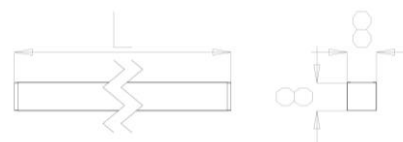

L=34 cm (8W/m)

H(m)	D(m)	E <sub>max</sub> (lx)	E <sub>av</sub> (lx)
100°			
0.60	1.52	150	49
1.20	3.05	37	12
1.80	4.57	17	5
2.40	6.09	9	3
3.00	7.62	6	2