

Projectors

● Plug&Play System

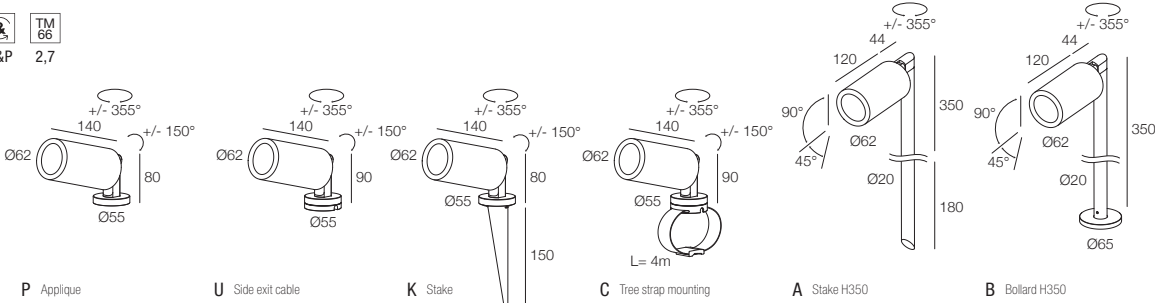

350 / 500mA	12W	18W
Lumen Output 3000K	350mA - 1250 lm	500mA - 1700 lm
12° Lens	7Q4568._____	7Q4569._____
18° Lens	784568._____	784569._____
24° Lens	7G4568._____	7G4569._____
33° Lens	7E4568._____	7E4569._____
52° Lens	754568._____	754569._____

24V	14W	18W
Lumen Output 3000K	24Vdc - 1250 lm	24Vdc - 1700 lm
12° Lens	7Q4724._____	7Q4725._____
18° Lens	784724._____	784725._____
24° Lens	7G4724._____	7G4725._____
33° Lens	7E4724._____	7E4725._____
52° Lens	754724._____	754725._____

FINISH	CCT	DECORATIVE RING	OPTICAL FILTER	FIXING
● 4 Black	● U1 2200K CRI > 90	● 4 Black	W Without Filter	P Applique
● M8 Brown	● B2 2400K CRI > 90	● 8 Satin Gold	E Elliptical Filter	U Side exit cable
● VC Fir Green	● X 2700K CRI > 90	● I Gold Chrome	H Hex Louver	K Stake
● 4A Anthracite Gray	● 6 3000K	● N Satin Nickel	P Prismatic Filter	C Tree strap mounting
● MS Bright Brown	● W 3000K CRI > 90	● 1 Shiny Chrome	S Softening Lens	A Stake H350
● 3 Gray	● K 3500K CRI > 90			B Bollard H350
● A6 Gray White	● D 4000K CRI > 90			



SUGGESTED DRIVERS (not included)

350mA	CC14-F-350-PI	p. 704
500mA	CC20-F-500-PI	p. 704
24Vdc	CV30-F-24-PI	p. 708

ACCESSORIES



INTERCHANGEABLE ACCESSORIES
p. 677

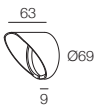

Low glare visor
A01448._0

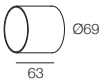

Low glare snoot
A01447._0

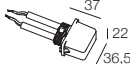

Watertight connector p. 682
A00387.40

EXAMPLE CODE COMPOSITION

123456.	FIXING
	OPTICAL FILTER
	DECORATIVE RING
	CCT
	FINISH