

Downlights

● Plug&Play System

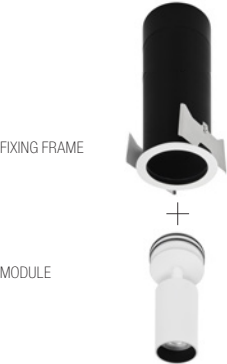

IP40

400

1130 g

Ø86  
[3 3/8"]

P&P

SD  
CM

TM  
66

IC

UL  
US  
LISTED

Saturno In&Out m Plug&Play fixing frame

|              |           |              |                   |
|--------------|-----------|--------------|-------------------|
| FIXING FRAME | A01771._0 | FRAME FINISH | See module finish |
|--------------|-----------|--------------|-------------------|

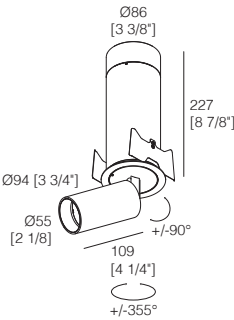

Saturno In&Out m Plug&Play module

|                             |                        |
|-----------------------------|------------------------|
| 400mA<br>Lumen Output 3000K | 14W<br>400mA - 1550 lm |
| 12° Lens                    | 7Q4936._ _ _ _ -UL     |
| 18° Lens                    | 784936._ _ _ _ -UL     |
| 24° Lens                    | 7G4936._ _ _ _ -UL     |
| 33° Lens                    | 7E4936._ _ _ _ -UL     |
| 52° Lens                    | 754936._ _ _ _ -UL     |

| MODULE FINISH     | CCT                 | DECORATIVE RING  | OPTICAL FILTER      |
|-------------------|---------------------|------------------|---------------------|
| ● H Black         | ● U1 2200K CRI > 90 | ● 4 Black        | W Without Filter    |
| ● M8 Brown        | ● B2 2400K CRI > 90 | ● I Gold Chrome  | E Elliptical Filter |
| ● G3 Gray         | ● X 2700K CRI > 90  | ● 8 Satin Gold   | H Hex Louver        |
| ● C Gothic Cement | ● X1 2700K CRI > 95 | ● N Satin Nickel | P Prismatic Filter  |
| ● G7 Beige Gray   | ● 6 3000K           | ● 1 Shiny Chrome | S Softening Lens    |
| ● A6 Gray White   | ● W 3000K CRI > 90  |                  |                     |
| ● S Warm White    | ● W1 3000K CRI > 95 |                  |                     |
| ○ 7 White         | ● K 3500K CRI > 90  |                  |                     |
|                   | ● K1 3500K CRI > 95 |                  |                     |
|                   | ● D 4000K CRI > 90  |                  |                     |



SUGGESTED DRIVERS (not included)

400mA CC36-R-400-NF p. 244

INTERCHANGEABLE ACCESSORIES



p. 235

EXAMPLE CODE COMPOSITION

