

Gemma 20 IP67 Solovetro

Solovetro series | IP67 | Class III | Dimmable

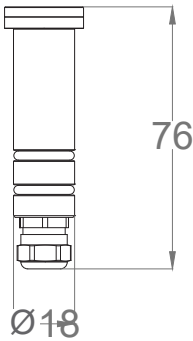
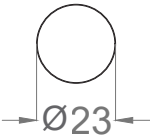

LIGHT SOURCE & OPTIC

Power
1W / 1,5W (24Vdc)
2W

Lens
15°
25°
40°
Frosted Glass

Beam Direction
Fixed
Symmetrical

Material
PMMA

LED quantity
1

Binning
2 MacAdam steps

Color temperature & quality
2200K CRI>80
2700K CRI>90
3000K CRI>90
4000K CRI>80

Lifetime
(L90) >55.000 hrs

FIXTURE

Dimensions
Ø 23mm x H 76mm

Material
Aluminium

Body finishes
Black
Champagne Gold
Gray

Weight
50gr

Mounting
Recessed

Fixing
Recessed box in aluminum with edge:
cut out Ø 26mm
Recessed box in plastic with closure cap

Working temperature
-20° / +40°

ELECTRICAL FEATURES

Power supply
Constant current:
350 mA (1W)
500 mA (2W)
Typical Vf= 3V (1/1,5 W - 2W)
Constant tension:
24Vdc

Driver requirement
Remote (not included)

Control
On/off
Push switch
Phase Cut
0/1-10 V
Casambi
DALI

Gemma 20 IP67 Solovetro

PHOTOMETRIC DATA (3000K CRI>90)

<div>1/1,5W - 15° UGR 1</div> <div></div> <div><table><tr><th>H (m)</th><th>D (m)</th><th>Eav (lx)</th></tr><tr><td>1</td><td>0.19</td><td>591</td></tr><tr><td>2</td><td>0.38</td><td>148</td></tr><tr><td>3</td><td>0.57</td><td>66</td></tr><tr><td>4</td><td>0.76</td><td>37</td></tr><tr><td>5</td><td>0.95</td><td>24</td></tr></table><div>Total lumen output 62 lm</div><div>Efficacy 62 lm/W (350mA) 41 lm/W (24Vdc)</div></div>	H (m)	D (m)	Eav (lx)	1	0.19	591	2	0.38	148	3	0.57	66	4	0.76	37	5	0.95	24	<div>1/1,5W - 25° UGR 13</div> <div></div> <div><table><tr><th>H (m)</th><th>D (m)</th><th>Eav (lx)</th></tr><tr><td>1</td><td>0.31</td><td>202</td></tr><tr><td>2</td><td>0.63</td><td>50</td></tr><tr><td>3</td><td>0.94</td><td>22</td></tr><tr><td>4</td><td>1.25</td><td>13</td></tr><tr><td>5</td><td>1.56</td><td>8</td></tr></table><div>Total lumen output 46 lm</div><div>Efficacy 46 lm/W (350mA) 31 lm/W (24Vdc)</div></div>	H (m)	D (m)	Eav (lx)	1	0.31	202	2	0.63	50	3	0.94	22	4	1.25	13	5	1.56	8	<div>1/1,5W - 40° UGR 13</div> <div></div> <div><table><tr><th>H (m)</th><th>D (m)</th><th>Eav (lx)</th></tr><tr><td>1</td><td>0.43</td><td>134</td></tr><tr><td>2</td><td>0.87</td><td>34</td></tr><tr><td>3</td><td>1.30</td><td>15</td></tr><tr><td>4</td><td>1.73</td><td>8</td></tr><tr><td>5</td><td>2.17</td><td>5</td></tr></table><div>Total lumen output 56 lm</div><div>Efficacy 56 lm/W (350mA) 37 lm/W (24Vdc)</div></div>	H (m)	D (m)	Eav (lx)	1	0.43	134	2	0.87	34	3	1.30	15	4	1.73	8	5	2.17	5	<div>1/1,5W - F.G. UGR 11</div> <div></div> <div><table><tr><th>H (m)</th><th>D (m)</th><th>Eav (lx)</th></tr><tr><td>1</td><td>0.70</td><td>8</td></tr><tr><td>2</td><td>1.40</td><td>2</td></tr><tr><td>3</td><td>2.11</td><td>1</td></tr><tr><td>4</td><td>2.81</td><td>1</td></tr><tr><td>5</td><td>3.51</td><td>0</td></tr></table><div>Total lumen output 7 lm</div><div>Efficacy 7 lm/W (350mA) 5 lm/W (24Vdc)</div></div>	H (m)	D (m)	Eav (lx)	1	0.70	8	2	1.40	2	3	2.11	1	4	2.81	1	5	3.51	0
H (m)	D (m)	Eav (lx)																																																																									
1	0.19	591																																																																									
2	0.38	148																																																																									
3	0.57	66																																																																									
4	0.76	37																																																																									
5	0.95	24																																																																									
H (m)	D (m)	Eav (lx)																																																																									
1	0.31	202																																																																									
2	0.63	50																																																																									
3	0.94	22																																																																									
4	1.25	13																																																																									
5	1.56	8																																																																									
H (m)	D (m)	Eav (lx)																																																																									
1	0.43	134																																																																									
2	0.87	34																																																																									
3	1.30	15																																																																									
4	1.73	8																																																																									
5	2.17	5																																																																									
H (m)	D (m)	Eav (lx)																																																																									
1	0.70	8																																																																									
2	1.40	2																																																																									
3	2.11	1																																																																									
4	2.81	1																																																																									
5	3.51	0																																																																									
<div>2W - 15° UGR 0</div> <div></div> <div><table><tr><th>H (m)</th><th>D (m)</th><th>Eav (lx)</th></tr><tr><td>1</td><td>0.19</td><td>793</td></tr><tr><td>2</td><td>0.38</td><td>198</td></tr><tr><td>3</td><td>0.57</td><td>88</td></tr><tr><td>4</td><td>0.76</td><td>50</td></tr><tr><td>5</td><td>0.95</td><td>32</td></tr></table><div>Total lumen output 75 lm</div><div>Efficacy 38 lm/W (350mA) 38 lm/W (24Vdc)</div></div>	H (m)	D (m)	Eav (lx)	1	0.19	793	2	0.38	198	3	0.57	88	4	0.76	50	5	0.95	32	<div>2W - 25° UGR 14</div> <div></div> <div><table><tr><th>H (m)</th><th>D (m)</th><th>Eav (lx)</th></tr><tr><td>1</td><td>0.31</td><td>266</td></tr><tr><td>2</td><td>0.62</td><td>66</td></tr><tr><td>3</td><td>0.94</td><td>30</td></tr><tr><td>4</td><td>1.25</td><td>17</td></tr><tr><td>5</td><td>1.56</td><td>11</td></tr></table><div>Total lumen output 60 lm</div><div>Efficacy 30 lm/W (350mA) 30 lm/W (24Vdc)</div></div>	H (m)	D (m)	Eav (lx)	1	0.31	266	2	0.62	66	3	0.94	30	4	1.25	17	5	1.56	11	<div>2W - 40° UGR 14</div> <div></div> <div><table><tr><th>H (m)</th><th>D (m)</th><th>Eav (lx)</th></tr><tr><td>1</td><td>0.40</td><td>178</td></tr><tr><td>2</td><td>0.81</td><td>45</td></tr><tr><td>3</td><td>1.21</td><td>20</td></tr><tr><td>4</td><td>1.61</td><td>11</td></tr><tr><td>5</td><td>2.02</td><td>7</td></tr></table><div>Total lumen output 68 lm</div><div>Efficacy 34 lm/W (350mA) 34 lm/W (24Vdc)</div></div>	H (m)	D (m)	Eav (lx)	1	0.40	178	2	0.81	45	3	1.21	20	4	1.61	11	5	2.02	7	<div>2W - F. G. UGR 12</div> <div></div> <div><table><tr><th>H (m)</th><th>D (m)</th><th>Eav (lx)</th></tr><tr><td>1</td><td>0.71</td><td>11</td></tr><tr><td>2</td><td>1.43</td><td>3</td></tr><tr><td>3</td><td>2.14</td><td>1</td></tr><tr><td>4</td><td>2.85</td><td>1</td></tr><tr><td>5</td><td>3.57</td><td>0</td></tr></table><div>Total lumen output 9 lm</div><div>Efficacy 5 lm/W (350mA) 5 lm/W (24Vdc)</div></div>	H (m)	D (m)	Eav (lx)	1	0.71	11	2	1.43	3	3	2.14	1	4	2.85	1	5	3.57	0
H (m)	D (m)	Eav (lx)																																																																									
1	0.19	793																																																																									
2	0.38	198																																																																									
3	0.57	88																																																																									
4	0.76	50																																																																									
5	0.95	32																																																																									
H (m)	D (m)	Eav (lx)																																																																									
1	0.31	266																																																																									
2	0.62	66																																																																									
3	0.94	30																																																																									
4	1.25	17																																																																									
5	1.56	11																																																																									
H (m)	D (m)	Eav (lx)																																																																									
1	0.40	178																																																																									
2	0.81	45																																																																									
3	1.21	20																																																																									
4	1.61	11																																																																									
5	2.02	7																																																																									
H (m)	D (m)	Eav (lx)																																																																									
1	0.71	11																																																																									
2	1.43	3																																																																									
3	2.14	1																																																																									
4	2.85	1																																																																									
5	3.57	0																																																																									

Product specifications and data are subject to change without warning, due to continue technical upgrades. Images are indicative of the quality and style of the product, but may not represent the precise details of the item you receive. Since we are constantly working to make improvements and for aesthetic reasons, cables and/or electrical elements are often not shown or specified. For further information please check our website www.dga.it or send us an e-mail to ufficiotecnico@dga.it | Vs 241125

Gemma 20 IP67 Solovetro

INSTALLATION ACCESSORIES

Recessed Box in aluminium with edge
(A00484._0)

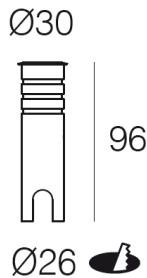

Recessed Box in plastic with closure cap
(A00479.40)

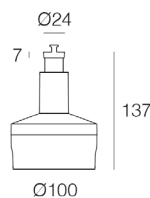

Removing tool
(A01295.60)

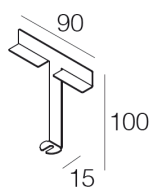

SUGGESTED REMOTE DRIVER

On/off:
CC14-F-350-PI / CC14-F-500-PI
CV30-F-24-PI



Multifunction (DALI 2):
CC10-D-350-PI / CC10-D-500-PI

