

## LIGHT SOURCE

LED quantity	12
Power max	8 W
Total lumen output (3000K)	8W: Opal glass - 443 lm
Efficacy lm/W (3000K)	8W: Opal glass - 55 lm/W
CRI	>80 – >90
LED Temperature	2700K – 3000K – 3000K CRI>90 – 4000K
Average operational life	50.000 hours

## OPTIC

Material	Polycarbonate
Available optics	Opal glass
Beam direction	Fixed
Flux symmetry	Symmetrical

## FIXTURE

Material	Aluminum, tempered glass
Available finishes	Powder coated: 7 - White H - Black L - Oyster white A - Gold B6 - Intense bronze 4Q – Agate grey
IP Rate	IP40
Working Temperature	-20° ÷ +40°
Integrated fixing Systems	-

## ELECTRICAL FEATURES

Driver	-
Dimmable	With triac dimmer
Connection	In parallel at 230 Vac
Class	I

## MECHANICAL FEATURES

Dimensions	Ø69 x 80 mm
Weight	290 gr
Installation	Wall, ceiling mounting
Cut-out	Ø53
Use	Indoor

## ACCESSORIES

Visors	-
Filters	-
Box/ Frame	-
Fixing system	-

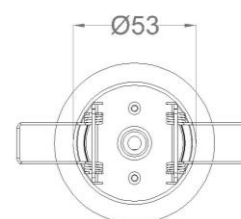
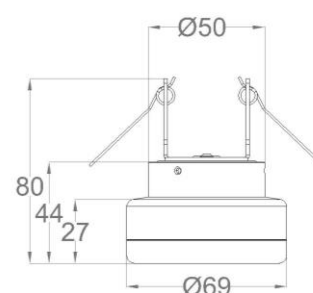

Luminaire protection device

85 x 20 x 20 mm

## PHOTOMETRIC DATA

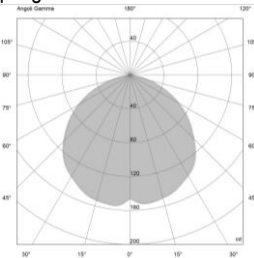
Opal glass – 8W						
						
H(m)	D(m)	E <sub>max</sub> (lx)	E <sub>av</sub> (lx)			
<b>Opal glass</b>						
<u>1.00</u>	3.03	153	39			
<u>2.00</u>	6.06	38	10			
<u>3.00</u>	9.08	17	4			
<u>4.00</u>	12.1	10	2			
<u>5.00</u>	15.1	6	2			

## NOTES

DRIVERLESS Technology:

Connect directly to the line voltage to 220-240Vac.

Provided with luminaire protection device.

It is mandatory to install the luminaire protection device included with the fixture on the main voltage. Please place a protection device for each fixture.