

Tini B Multi

Low voltage track projectors | IP40 | Class III | Dimmable

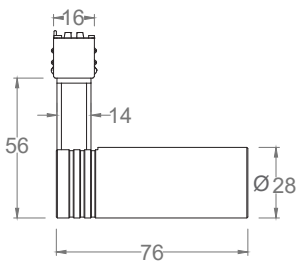
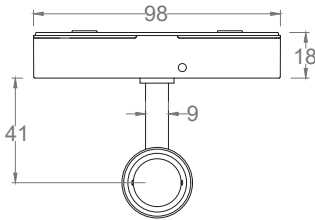

LIGHT SOURCE & OPTIC

Power
4W

Lens
15°/30°/60°/Elliptical

Beam Direction
Adjustable:
Tilting +/-90°, rotating +/-355°
Symmetrical

Material
PMMA

LED quantity
1

Binning
2 MacAdam steps

Color temperature & quality
2200K CRI>80
2700K CRI>80/90
3000K CRI>80/90
4000K CRI>80
5000K CRI>80

Lifetime (Ta 25°)
L80 >60.000 hrs

Output (3000K CRI>90)
357 lm

FIXTURE

Dimensions
Ø 28mm x H 76mm (cylinder)

Material
Aluminium

Body finishes
Black (RAL 9005)
Dark Bronze
White (RAL 9003)

Weight
100gr

Mounting
On track

Fixing
Track Connector

Working temperature
-20° / +40°

ELECTRICAL FEATURES

Power supply
Constant tension:
24-48Vdc
Typical Vf= 3V x 3

Driver requirement
Remote (not included)

Control
On/off
DALI
Broadcast

Tini B Multi

PHOTOMETRIC DATA (3000K CRI>90)

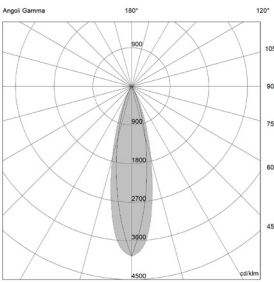
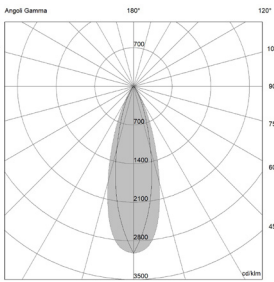
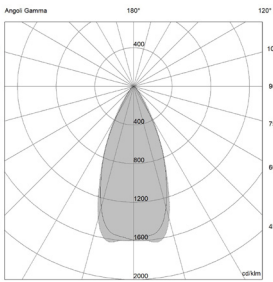
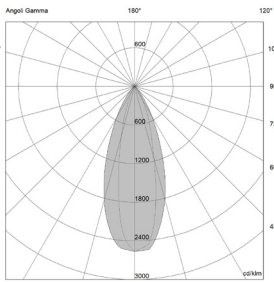
4W - 15° UGR 16			4W - 30° UGR 19			4W - 60° UGR 21			4W- 25°x40° UGR 15		
											
H (m)	D (m)	Eav (lx)	H (m)	D (m)	Eav (lx)	H (m)	D (m)	Eav (lx)	H (m)	D (m)	Eav (lx)
1	0.37	462	1	0.45	328	1	0.85	119	1	0.44-0.75	452
2	0.73	115	2	0.89	82	2	1.69	30	2	0.89-1.50	113
3	1.10	51	3	1.34	36	3	2.54	13	3	1.33-2.25	50
4	1.47	29	4	1.78	21	4	3.39	7	4	1.78-3.00	28
5	1.83	18	5	2.23	13	5	4.23	5	5	2.22-3.35	18
Total lumen output 192 lm			Total lumen output 178 lm			Total lumen output 129 lm			Total lumen output 283 lm		
Efficacy 48 lm/W			Efficacy 44 lm/W			Efficacy 32 lm/W			Efficacy 71 lm/W		

Tini B Multi

INSTALLATION ACCESSORIES

Compatible with 24-48Vdc Multi Track:

Standard track (A01048._0)

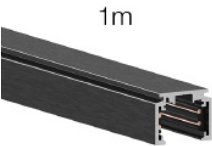

Trimless track (A01402._0)

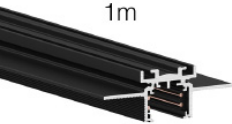

Suspended track (A01351._0)

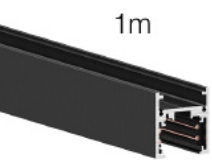

SUGGESTED REMOTE DRIVER

On/Off :

CC70-F-24-N

CV70-F-48-N

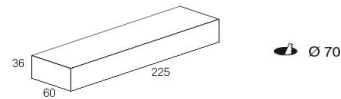

For On/Off and DALI version.
Please consider 1 address for each DALI projector.

Multifunction (DALI 2, 0/1-10V, PUSH):

CV75-DM-24-NI

CV75-DM-48-NI

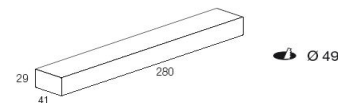

For Broadcast version.
Please consider 1 address for each driver in case of DALI control.

Other options upon request