

Saturno mR Plug&Play

Manuale d'uso e installazione

Installation and user manual - Notice d'installation et d'usage - Bedienungsanleitung - Manual de instalación y uso

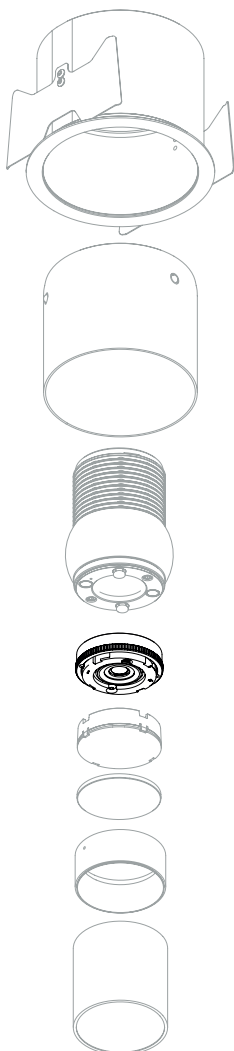

Prima di iniziare l'installazione e ad ogni controllo e manutenzione, disinserire la tensione di alimentazione agendo sull'interruttore generale dell'impianto elettrico.

Before starting the installation or any test and maintenance, shut the power off by switching of the main switch.

Avant de commencer le montage ou à chaque contrôle et maintenance, couper la tensions de l'alimentation, per l'interrupteur général de l'installation électrique.

Bei Einbau-, Test- oder Wartungsarbeiten der Hauptschalter ausschalten.

Antes de empezar el ensamblaje, en cada control y mantenimiento, desconectar la fuente de alimentación, actuando en el interruptor principal del sistema eléctrico.

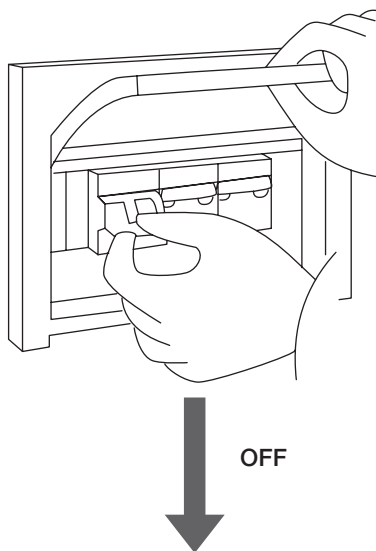

1. SMONTAGGIO

Disassembly - Dépose - Abbau - Desmontaje

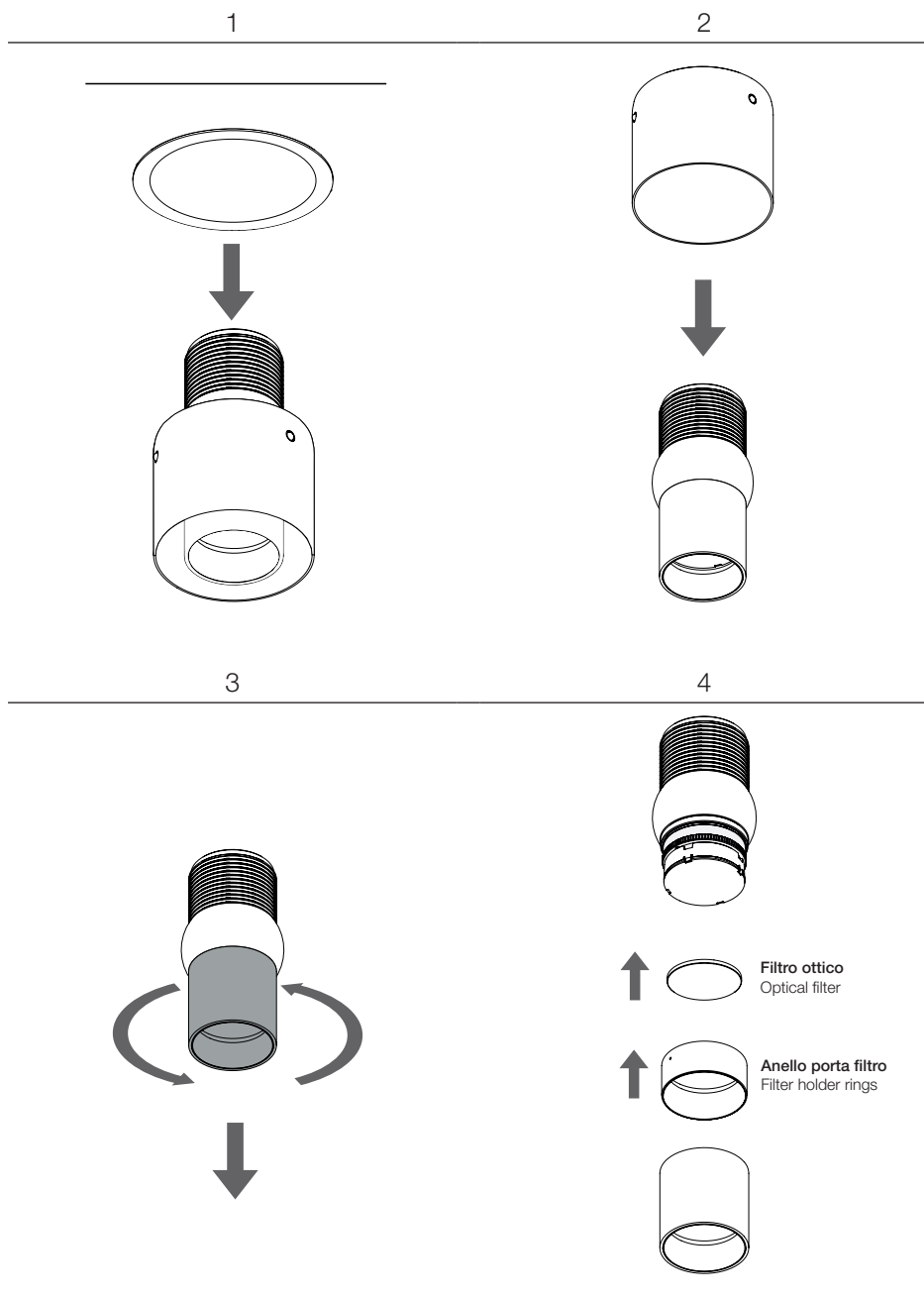

5

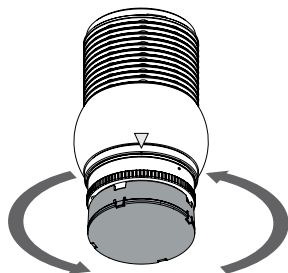

Lente
Lens

6

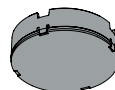
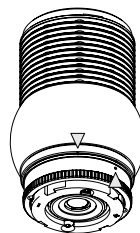

7

 **ATTENZIONE - CAUTION - ATTENTION - ACHTUNG - CUIDADO**

Non toccare il LED.

Do not touch the LED.

Ne touchez pas la LED svp.

Sie nicht die LED.

No tocar el LED.

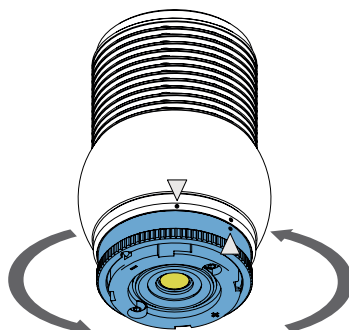

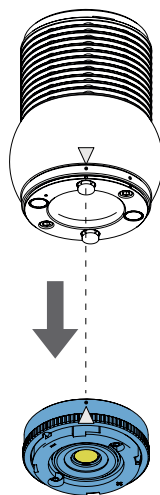
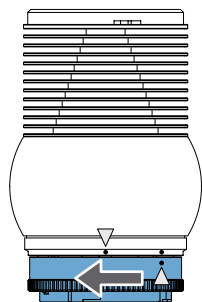

2. MONTAGGIO MECCANICO

Mechanical mounting - Montage mécanique - Zusammenbau - Montaje mecánico

1

 **ATTENZIONE** - CAUTION - ATTENTION - ACHTUNG - CUIDADO

Non toccare il LED.

Do not touch the LED.

Ne touchez pas la LED svp.

Sie nicht die LED.

No tocar el LED.

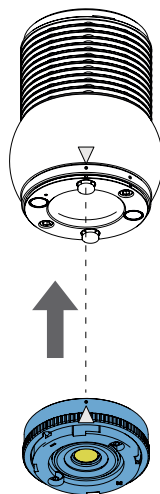

2

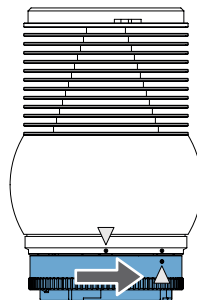
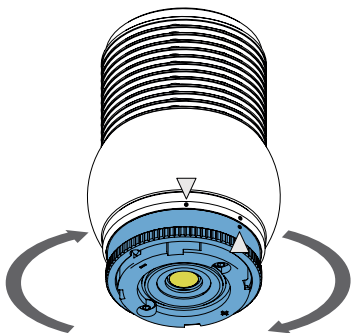

Bloccato
Locked

3

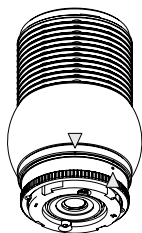

Lente
Lens

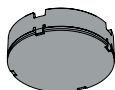

4

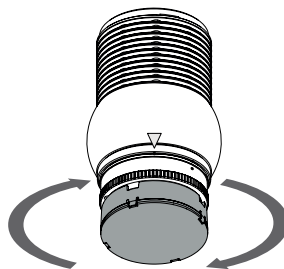

5



Filtro ottico
Optical filter



Anello porta filtro
Filter holder rings

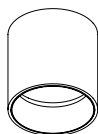

6

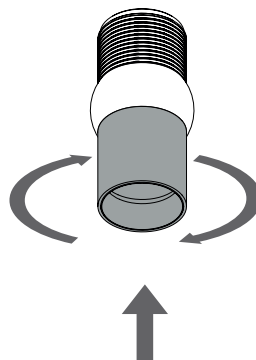

7

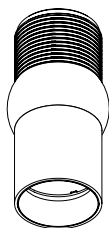
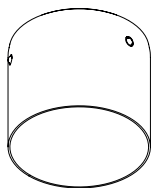

8

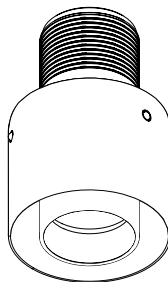

Saturno mR Plug&Play W 26-13

DGA

Via P. Nenni 72/B int.G/H 50013 Campi Bisenzio (FI) – Italy Tel. +39 055 8986235
E-mail: info@dga.it – Internet: www.dga.it