

# Star 3 with flat laminated springs

Small downlights | IP40 | Class III | Dimmable

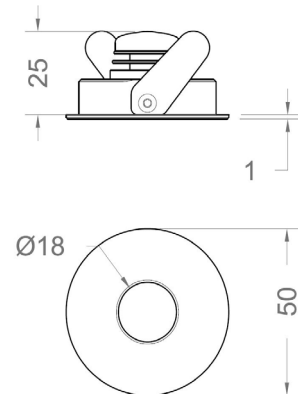

## LIGHT SOURCE & OPTIC

### Power

3W

### Lens

15°  
30°  
60°  
elliptical lens

### Beam Direction

Fixed, Symmetrical/ Asymmetrical

### Material

PMMA

### LED quantity

3

### Binning

2 MacAdam step

### Color temperature & quality

2200K CRI>80  
2700K CRI>80  
3000K CRI>80/90  
4000K CRI>80

### Lifetime

(L90) >60.000 hrs

## FIXTURE

### Dimensions

Ø 50mm x H 26mm

### Material

Aluminium

### Body finishes

Black  
Bronze  
Gray  
White (RAL 9003)

### Weight

58gr

### Mounting

Recessed: cut out Ø 44mm

### Fixing

Springs

### Working temperature

-20° / +40°

## ELECTRICAL FEATURES

### Power supply

Constant current:  
350 mA  
Typical Vf= 3x3V

### Driver requirement

Remote (not included)

### Control

On/off  
Push switch  
Phase Cut  
0/1-10 V  
Casambi  
DALI

# Star 3 with flat laminated springs

## PHOTOMETRIC DATA (3000K CRI>80)

### 3W - 15° | UGR 16

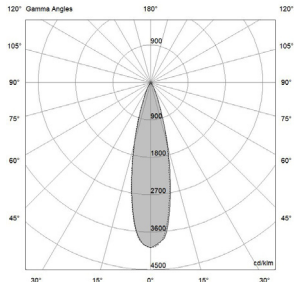

H (m)	D (m)	Eav (lx)
1	0.46	828
2	0.92	207
3	1.37	92
4	1.83	52
5	2.29	33

**Total lumen output**  
328 lm

**Efficacy**  
109 lm/W

### 3W - 30° | UGR 19

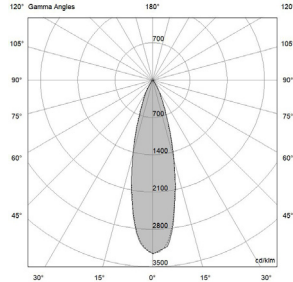

H (m)	D (m)	Eav (lx)
1	0.50	634
2	1.00	158
3	1.50	70
4	2.00	40
5	2.50	25

**Total lumen output**  
315 lm

**Efficacy**  
105 lm/W

### 3W - 60° | UGR 22

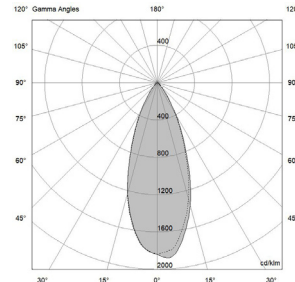

H (m)	D (m)	Eav (lx)
1	0.70	273
2	1.41	68
3	2.11	30
4	2.81	17
5	3.51	11

**Total lumen output**  
247 lm

**Efficacy**  
82 lm/W

### 3W - 20°x40° | UGR 22

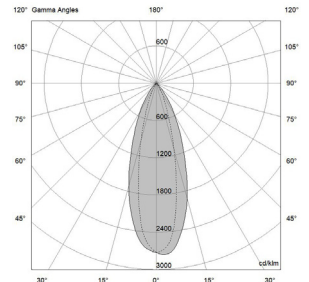

H (m)	D (m)	Eav (lx)
1	0.69	512
2	1.37	128
3	2.06	57
4	2.75	32
5	3.43	20

**Total lumen output**  
300 lm

**Efficacy**  
100 lm/W

# Star 3 with flat laminated springs

## SUGGESTED REMOTE DRIVERS

### On/Off :

CC20-F-350-N

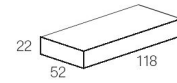

 Ø 55

### Multifunction (DALI 2, 0/1-10V, PUSH RIPPLE FREE, AM DIMMING):

CC25-DM-350-N

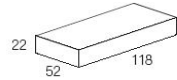

 Ø 55

Other options upon request