

Odino 6P

Projectors | IP67 | Class II | Dimmable

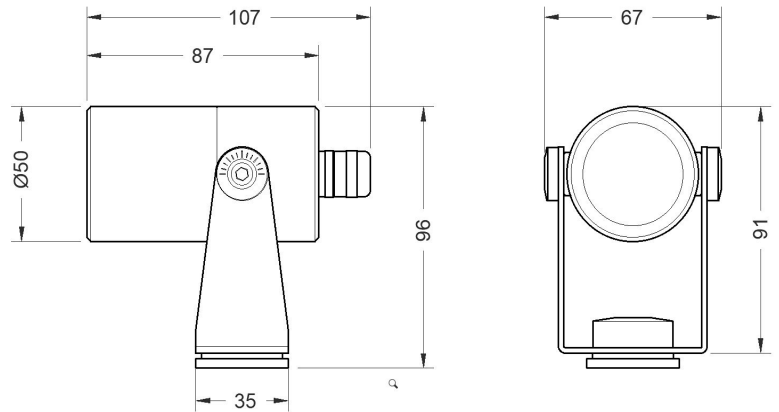

LIGHT SOURCE & OPTIC

Power

6W

Lens

30°

50°

Beam Direction

Adjustable:

Tilting +/-120°, rotating +/-355°,

Symmetrical

Material

PMMA + glass

LED quantity

1

Binning

2 MacAdam steps

Color temperature & quality

2700K CRI>80

3000K CRI>80

Lifetime

(L85) >50.000 hrs

FIXTURE

Dimensions

Ø 50mm x H 107mm (cylinder)

Material

Aluminium

Body finishes

Black

Dark bronze

Gray

Weight

350gr

Mounting

On surface

Fixing

Applique

Working temperature

-20° / +40°

ELECTRICAL FEATURES

Power supply

Main voltage:

220-240Vac

Driver requirement

Driverless technology

Control

On/off

DALI (with optional dimmer-not included)

Feature

Water Infiltration Protection System

Odino 6P

PHOTOMETRIC DATA (3000K CRI>80)

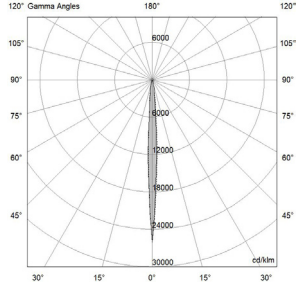
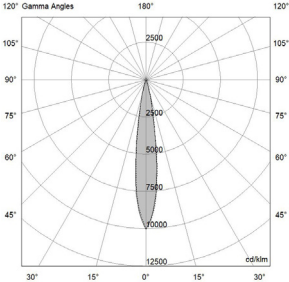
6W - 30° UGR 12			6W - 50° UGR 14		
					
H (m)	D (m)	Eav (lx)	H (m)	D (m)	Eav (lx)
1	0.55	412	1	0.82	147
2	1.10	103	2	1.65	37
3	1.65	46	3	2.47	16
4	2.20	26	4	3.29	9
5	2.75	16	5	4.12	6
Total lumen output 228 lm			Total lumen output 139 lm		
Efficacy 38 lm/W			Efficacy 23 lm/W		

Odino 6P

ACCESSORIES

Low glare visor (A00519._0)

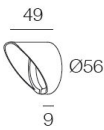

Low glare snoot (A00848._0)

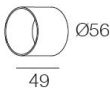

INSTALLATION ACCESSORIES

Stainless Steel 316L stake (A00281.60)

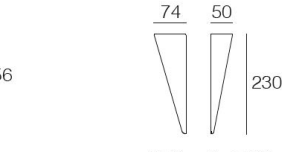

Watertight connector (A01023.40)

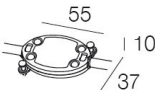

SUGGESTED REMOTE DRIVER

Dimmable (DALI):
D300-D-1CH-NT

