

Asymmetric Linear IP40

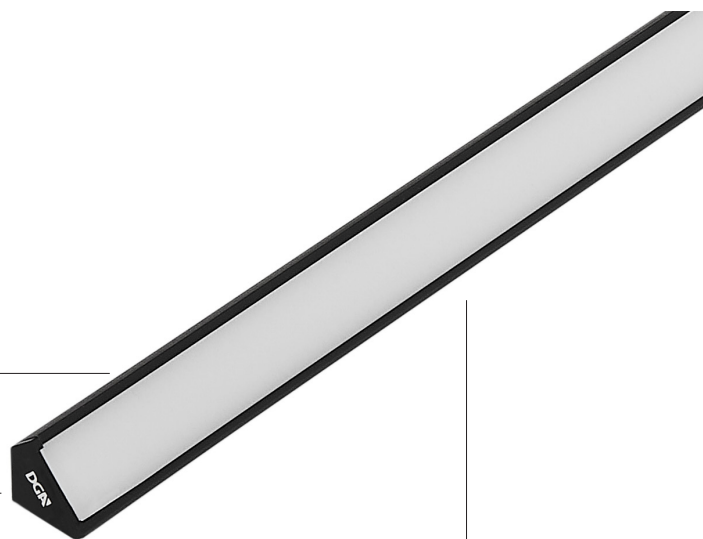

discover more



COVER



END CAP

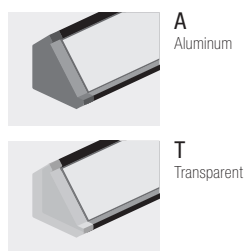

EXIT CABLE

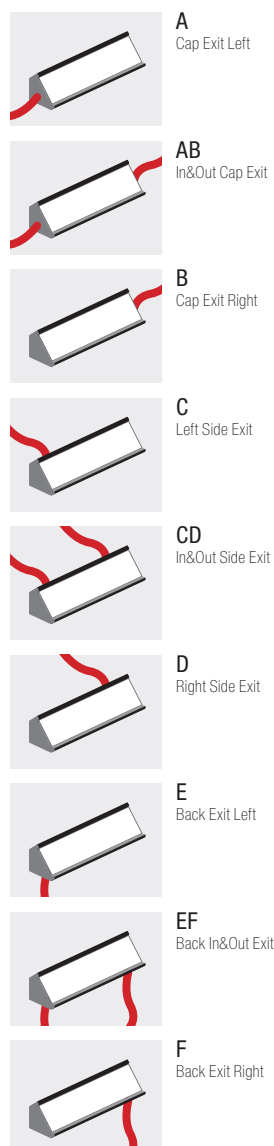

FIXING ELEMENTS

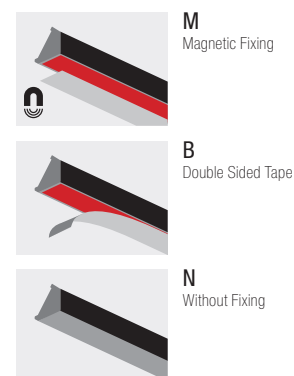

FIXING

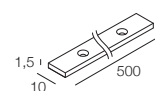
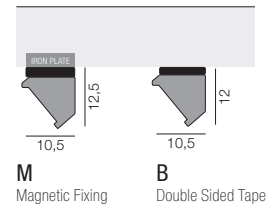

Iron plate for M Magnetic Fixing
A01745.H0

Asymmetric Linear IP40

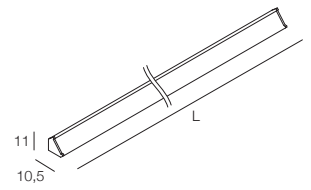
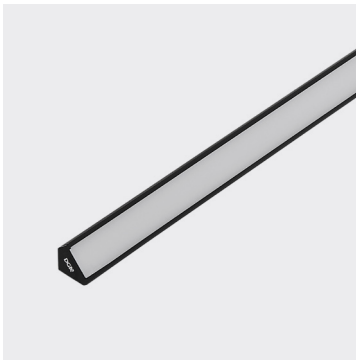

Lumen Output 3000K CRI > 90

23W/m - Opal Cover - Finish Gray: 1360 lm/m

CODE
LNG2- [] - [] - [] - [] - [] - [] - []

POWER	LENGTH (cm)										COVER	END CAP	EXIT CABLE	FIXING	FINISH	CCT
08 8W/m	004	007	010	013	016	019	022	025	028	031	OPL	A	A	M	● 4	● U
12 12W/m	034	037	040	043	046	049	052	055	058	061	MLK	T	AB	B	● 3	● Q
16 16W/m	064	067	070	073	076	079	082	085	088	091	BLK		B	N		● X
19 19W/m	094	097	100	103	106	109	112	115	118	121			C			● W
23 23W/m	124	127	130	133	136	139	142	145	148	151			CD			● K
	154	157	160	163	166	169	172	175	178	181			D			● D
	184	187	190	193	196	199	202	205	208	211			E			
	214	217	220	223	226	229	232	235	238	241			EF			
	244	247	250	253	256	259	262	265	268	271			F			
	274	277	280	283	286	289	292	295	298							

Custom lengths upon request

ACCESSORIES (only for N without fixing)

BRACKETS WITH SCREWS

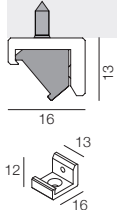

Bracket with screw 0°
A01621_0

MOUNTING CLIP



Mounting clip
A01612.60

SUGGESTED DRIVERS (not included)

24Vdc CV70-F-24-N p. 292