

Aurora Zoom 1500

Track and surface zoom projectors | IP40 | Class II | Dimmable

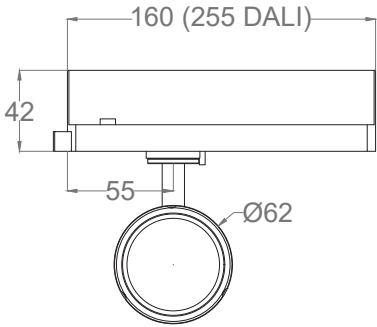
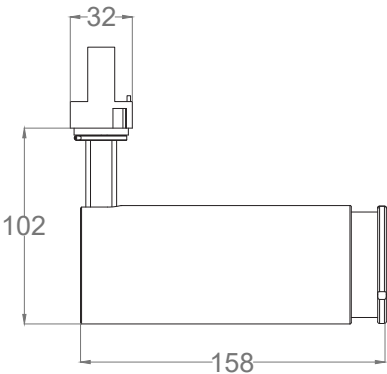

LIGHT SOURCE & OPTIC

Power
18W

Lens
Zoom 9°>40°

Beam Direction
Adjustable:
Tilting +/-90°, rotating +/-355°,
Symmetrical

Material
Glass

LED quantity
1

Binning
2 MacAdam steps

Color temperature & quality
2700K CRI>80
3000K CRI>80
3000K CRI>90
4000K CRI>90

Lifetime
(L90) >60.000 hrs

FIXTURE

Dimensions
Ø 61mm x H 158 mm (cylinder)

Material
Aluminium

Body finishes
Black (RAL 9005)
White (RAL 9003)
All White (RAL 9003)

Weight
750gr

Mounting
On Track

Fixing
Track Connector

Working temperature
-20° / +40°

ELECTRICAL FEATURES

Power supply
Main Voltage:
220-240ac

Driver requirement
Built-in driver

Control
On/off
DALI

Aurora Zoom 1500

PHOTOMETRIC DATA (3000K CRI>80)

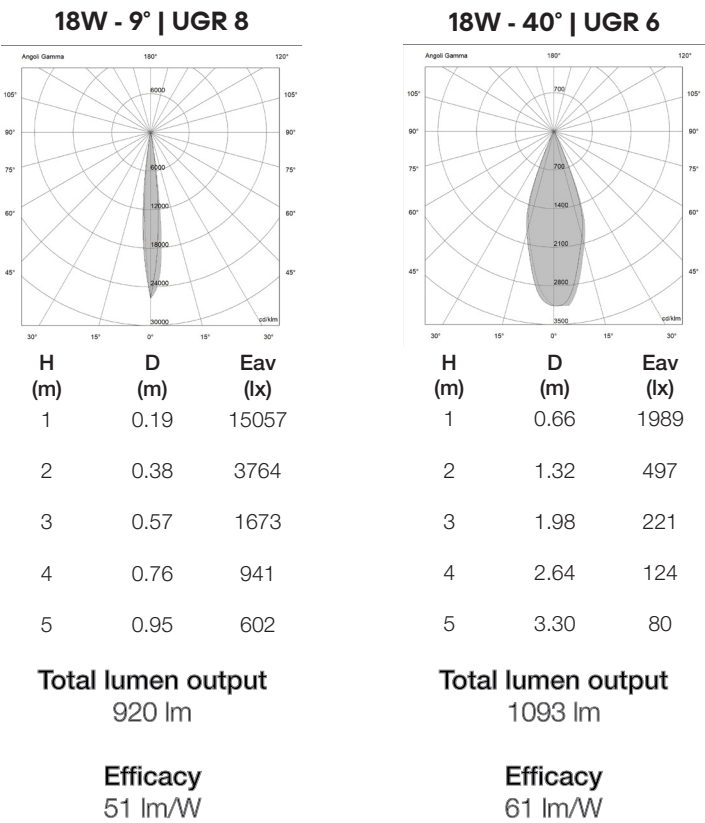

Aurora Zoom 1500

INSTALLATION ACCESSORIES

Compatible with 230Vac Track:

Surface and suspended track (A01668._0)
1m

