

Saturno

Projectors



[1] 12° Lens not interchangeable

IP40

500

450 g

2

SD
CM

TM
66

	500mA	18W
	Lumen Output 3000K	500mA - 2100 lm
12° Lens [1]	7Q4770	_____
18° Lens	784770	_____
24° Lens	7G4770	_____
33° Lens	7E4770	_____
52° Lens	754770	_____

FINISH	CCT	DECORATIVE RING	OPTICAL FILTER	FIXING
H Black	U1 2200K CRI > 90	4 Black	Without Filter	Springs
M8 Brown	B2 2400K CRI > 90	8 Satin Gold	Elliptical Filter	Base for inner connection
G3 Gray	X 2700K CRI > 90	I Gold Chrome	Hex Louver	
C Gothic Cement	X1 2700K CRI > 95	N Satin Nickel	Prismatic Filter	
G7 Beige Gray	6 3000K	1 Shiny Chrome	Softening Lens	
A6 Gray White	W 3000K CRI > 90			
S Warm White	W1 3000K CRI > 95			
7 White	K 3500K CRI > 90			
	K1 3500K CRI > 95			
	D 4000K CRI > 90			

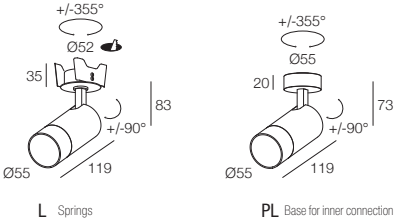

SUGGESTED DRIVERS (not included)

500mA CC20-F-500-N p. 700

INTERCHANGEABLE ACCESSORIES



p. 677

EXAMPLE CODE COMPOSITION

123456.