

LIGHT SOURCE

LED quantity	1	
Power max	1 W – 2 W	
Total lumen output (3000K CRI>90)	Lui 1 - 1W: 14 lm Lui 2 - 1W: 10 lm Lui 3 - 1W: 6 lm	Lui 1 - 2W: 20 lm Lui 2 - 2W: 14 lm Lui 3 - 2W: 7 lm
Efficacy lm/W (3000K CRI>90)	Lui 1 - 1W: 14 lm/W Lui 2 - 1W: 5 lm/W Lui 3 - 1W: 6 lm/W	Lui 1 - 2W: 10 lm/W Lui 2 - 2W: 7 lm/W Lui 3 - 2W: 3,5 lm/W
CRI	>80	
LED Temperature	2200K–2700K– 3000K - 4000K	
Average operational life	50.000 hours	

OPTIC

Material	PMMA
Available optics	45°
Beam direction	Fixed
Flux symmetry	Asymmetrical

FIXTURE

Material	Aluminum/ glass
Available finishes	Screen printing on glass: 3 - Grey 4 - Black 7 - White
IP Rate	IP67
Working Temperature	-20° ÷ +40°
Integrated fixing Systems	-

ELECTRICAL FEATURES

Driver	Remote
Dimmable	Push, 1-10, DALI
Connection	In series at 350mA – 500mA
Class	III

MECHANICAL FEATURES

Dimensions	Ø35 x 65 mm (without frame)
Weight	115 gr
Installation	Wall recessed
Cut-out	Ø31 mm – spring support Ø33 mm - recessed box Ø38 mm - recessed box with edge Ø50 mm - frame for trimless installation
Use	Outdoor

ACCESSORIES

Interchangeable lenses	-
Filters	-
Visors	-
Box/ Frame	Spring support (A01457.60) Frame for trimless installation (A01449.30) Recessed box with edge (A01450._0) Recessed box (A01451.40)
Installation tool	Hole saw (A00832.H0)

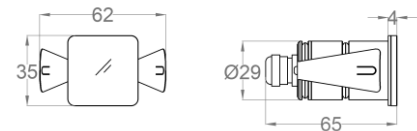
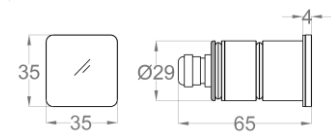

Spring mounting support

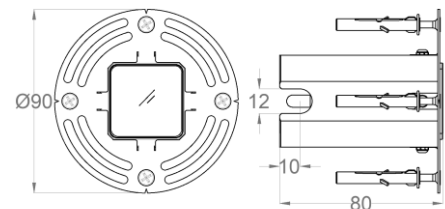

Frame for trimless installation

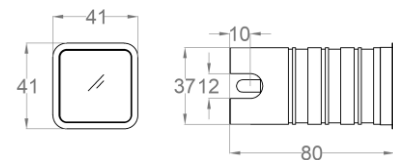

Recessed box with edge

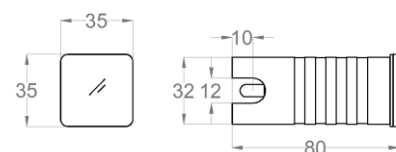

Recessed box

PHOTOMETRIC DATA

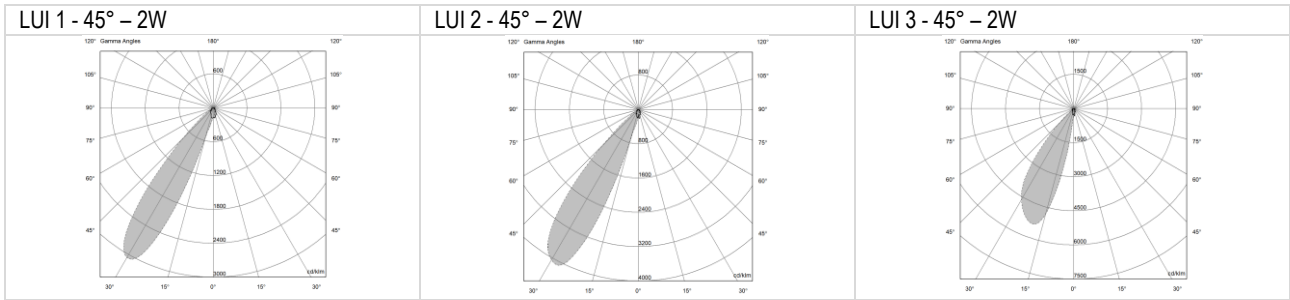

NOTES
