

# Armonia curva Opal cover

Linear System | IP40 | Class III | Dimmable

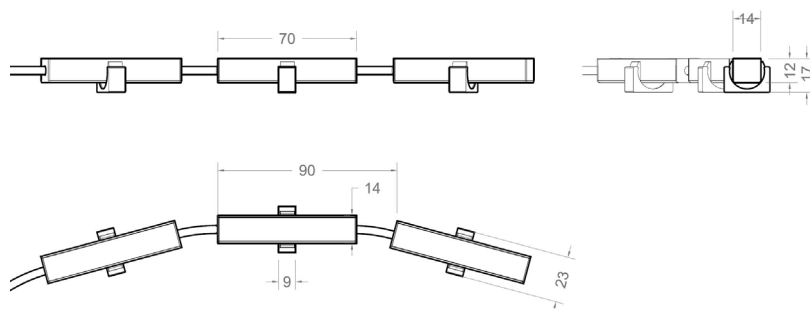

## Integrated Fixing\*

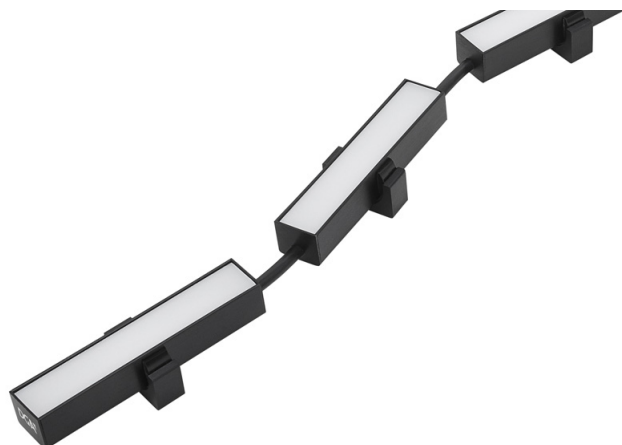
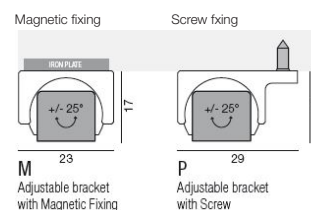

## LIGHT SOURCE & OPTIC

### Power

15W/m

### Lens

Transparent Cover, (6%)  
Opal Cover (25%)  
Black Ghost Cover (80%)

### Beam Direction

Fixed, Symmetrical

### Material

PMM

### LED quantity

179

### Binning

2 MacAdam step

### Color temperature & quality

2200K  
2500K  
2700K CRI>90  
3000K CRI>90  
3500K CRI>90  
4000K CRI>90

### Lifetime

L85 >95.000 hrs

## FIXTURE

### Dimensions

D 23-29mm x H 17mm x L:

007 016 025 034 052 070 079 088 097 106  
115 124 133 142

### Material

Aluminum

### Body finishes

Black  
Gray

### Weight

220gr/m

### Mounting

On surface

### End caps

Aluminum

### Fixing\*

Adjustable bracket with Magnetic Fixing  
Adjustable bracket with Screw

### Working temperature

-20° / +40°

## ELECTRICAL FEATURES

### Power supply

Constant tension: 12 Vdc

### Driver

Remote (not included)

### Control

On/off  
Push switch  
Phase Cut  
0/1-10 V  
Casambi  
DALI

### Cable exit

In&Out cap exit



# Armonia curva Opal cover

PHOTOMETRIC DATA (3000K CRI>90-Opal Cover-L.70mm)

2W - 103° | UGR 29

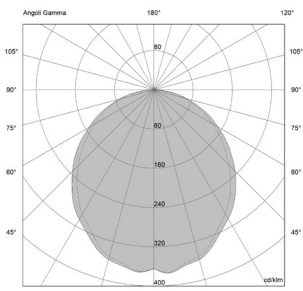

H (m)	D (m)	Eav (lx)
1	2.53	7
2	5.06	2
3	7.59	1
4	10.12	0
5	12.65	0

Total lumen output  
60 lm

Efficacy  
30 lm/W

# Armonia curva Opal cover

## INSTALLATION ACCESSORIES

### Iron plate

Only for Armonia with magnetic fixing



## SUGGESTED REMOTE DRIVERS

### On/Off :

CV70-F-12-N

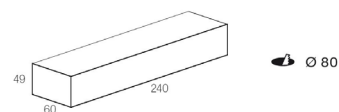

Other options upon request