

# Ariel P IP67 Plug&Play-Side exit

Projectors | IP67 | Class III | Dimmable

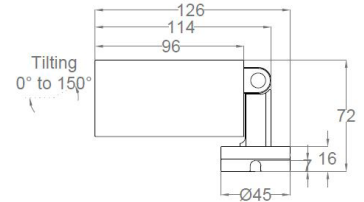

U)

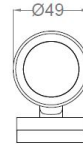
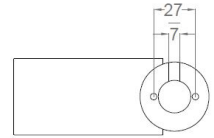

## LIGHT SOURCE & OPTIC

### Power

9 W (9,5W - 24Vdc)  
13 W (13W - 24Vdc)

### Lens

14° - not interchangeable  
18°/ 24°/ 33°/ 52° - interchangeable

### Beam Direction

Adjustable:  
Tilting +/-150°, rotating +/-355°,  
Symmetrical

### Material

PMMA + glass

### LED quantity

1

### Binning

2 MacAdam steps

### Color temperature & quality

2200K CRI>90  
2400K CRI>90  
2700K CRI>90  
3000K CRI>80/90  
3500K CRI>90  
4000K CRI>90

### Lifetime (Ta 25°)

L70 >77.000 hrs

### Output (3000K CRI>90)

14°: 872 lm  
18°/ 24°/ 33°/ 52°: 1020 lm

## FIXTURE

### Dimensions

Ø 49mm x H 96mm (cylinder)

### Material

Aluminium

### Module finishes

Gray White (RAL 9002)  
Gray (RAL 7012)  
Bright Brown (RAL 4061)  
Anthracite gray (RAL 7016)  
Fir Green (RAL 6009)  
Brown (RAL 8019)  
Black (RAL 9005)

### Filter holder finishes

Gold Chrome  
Shiny Chrome  
Satin Gold  
Satin Nickel  
Black

### Weight

400gr

### Mounting

On surface

### Fixing

U - Side exit cable (screws)  
\*other options available

### Working temperature

-20° / +40°

## ELECTRICAL FEATURES

### Power supply

Constant current:  
500 mA (9W)  
700 mA (13W)  
Typical Vf= 18V  
Constant tension:  
24Vdc (9,5-13W)

### Driver requirement

Remote (not included)

### Control

On/off  
Push switch  
Phase Cut  
0/1-10 V  
Casambi  
DALI

### Feature

Water Infiltration Protection System

# Ariel P IP67 Plug&Play-Side exit

## PHOTOMETRIC DATA (3000K CRI>90)

### 9/9,5W - 14° | UGR 10

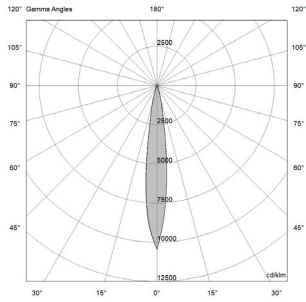

H (m)	D (m)	Eav (lx)
1	0.25	4298
2	0.50	1074
3	0.76	478
4	1.01	269
5	1.26	172

**Total lumen output**  
659 lm

**Efficacy**  
73 lm/W (500 mA)  
69 lm/W (24Vdc)

### 9/9,5W - 18° | UGR 13

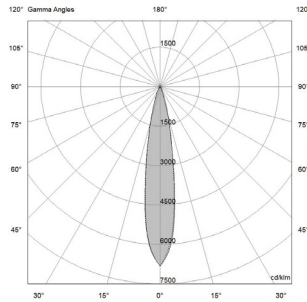

H (m)	D (m)	Eav (lx)
1	0.32	3087
2	0.64	772
3	0.96	343
4	1.28	193
5	1.60	123

**Total lumen output**  
711 lm

**Efficacy**  
79 lm/W (500 mA)  
75 lm/W (24Vdc)

### 9/9,5W - 24° | UGR 15

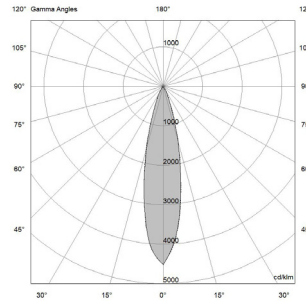

H (m)	D (m)	Eav (lx)
1	0.41	1919
2	0.83	480
3	1.24	213
4	1.65	120
5	2.22	77

**Total lumen output**  
686 lm

**Efficacy**  
76 lm/W (500 mA)  
72 lm/W (24Vdc)

### 9/9,5W - 33° | UGR 17

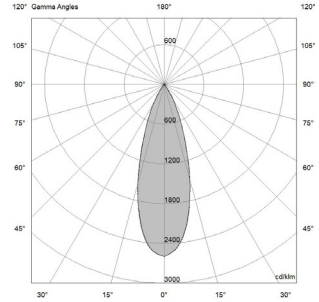

H (m)	D (m)	Eav (lx)
1	0.60	980
2	1.21	245
3	1.81	109
4	2.41	61
5	3.02	39

**Total lumen output**  
618 lm

**Efficacy**  
69 lm/W (500 mA)  
65 lm/W (24Vdc)

### 9/9,5W - 52° | UGR 21

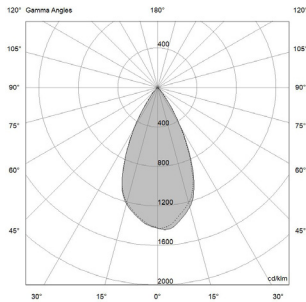

H (m)	D (m)	Eav (lx)
1	0.97	550
2	1.94	138
3	2.91	61
4	3.88	34
5	4.85	22

**Total lumen output**  
683 lm

**Efficacy**  
76 lm/W (500 mA)  
72 lm/W (24Vdc)

# Ariel P IP67 Plug&Play-Side exit

## PHOTOMETRIC DATA (3000K CRI>90)

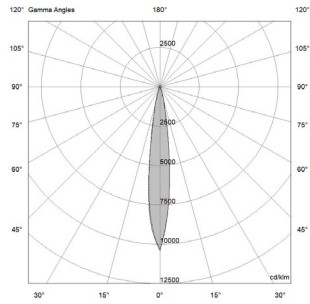
**13W - 14° | UGR 8**

H (m)	D (m)	Eav (lx)
1	0.33	3555
2	0.65	889
3	0.98	395
4	1.31	222
5	1.63	142

**Total lumen output**  
763 lm

**Efficacy**  
59 lm/W

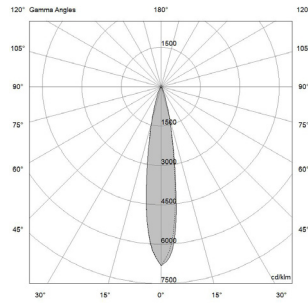
**13W - 18° | UGR 12**

H (m)	D (m)	Eav (lx)
1	0.37	3253
2	0.74	813
3	1.11	361
4	1.48	203
5	1.86	130

**Total lumen output**  
887 lm

**Efficacy**  
68 lm/W

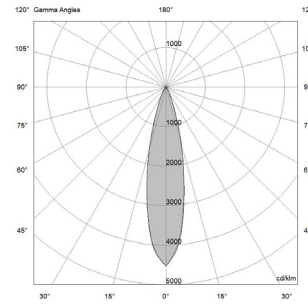
**13W - 24° | UGR 13**

H (m)	D (m)	Eav (lx)
1	0.46	2221
2	0.92	555
3	1.38	247
4	1.84	139
5	2.30	89

**Total lumen output**  
890 lm

**Efficacy**  
68 lm/W

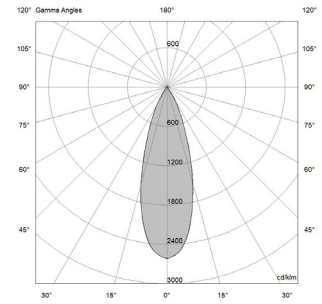
**13W - 33° | UGR 15**

H (m)	D (m)	Eav (lx)
1	0.62	1272
2	1.24	318
3	1.86	141
4	2.48	80
5	3.10	51

**Total lumen output**  
800 lm

**Efficacy**  
61 lm/W

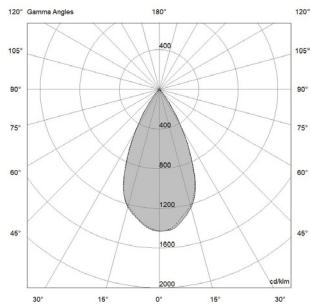
**13W - 52° | UGR 21**

H (m)	D (m)	Eav (lx)
1	0.92	757
2	1.83	189
3	2.75	84
4	3.67	47
5	4.58	30

**Total lumen output**  
880 lm

**Efficacy**  
68 lm/W

# Ariel P IP67 Plug&Play-Side exit

## INTERCHANGEABLE ACCESSORIES

### Plug&Play Modules (CCT)

(A01475.\_ \_)

For 14° lens:

2200K CRI>90  
2400K CRI>90  
2700K CRI>90/95  
3000K CRI>80/90/95  
3500K CRI>90/95  
4000K CRI>90

For 18° / 24° / 33° / 52° lens:

2200K CRI>90  
2400K CRI>90  
2700K CRI>90/95  
3000K CRI>80/90/95  
3500K CRI>90/95  
4000K CRI>90

### Lenses



18° Lens  
(A01192.80)  
24° Lens  
(A01193.80)  
33° Lens  
(A01194.80)  
52° Lens  
(A01195.80)

### Optical filters



Elliptical Filter  
(A01182.80)



Hex Louver  
(A01183.40)



Prismatic Filter  
(A01184.80)



Softening Lens  
(A01184.80)

### Decorative rings

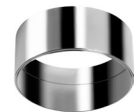

Shiny Chrome  
(A01272.10)



Gold Chrome  
(A01272.10)



SatinGold  
(A01272.80)



SatinNickel  
(A01272.N0)



Black  
(A01272.40)

## INSTALLATION ACCESSORIES

Low glare visor (A00519.\_0)

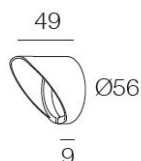

Low glare snoot (A00848.\_0)

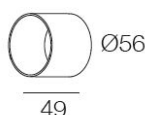

Watertight connector (A00387.40)

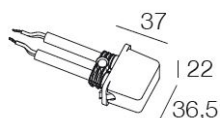

## SUGGESTED REMOTE DRIVER

### On/off:

CC14-F-500/700-PI

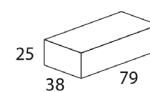

Ø 44

CV30-F-24-PI

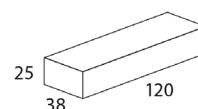

Ø 44

### Dimmable (DALI 2):

CC10-D-500/700-PI

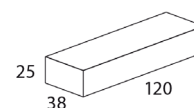

Ø 44

CV25-D-24-PI

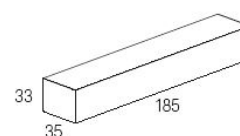

Ø 60

Other options upon request